



# BUILDING BOXEL

## New Georeferenced Space Measure

The Building Boxel is a 10x10x10 feet cuboid georeferenced on Earth. The coordinate of Boxel needs only 10 alphanumeric characters of base 64 encoding to render it unique on the planet. Therefore, this unique space identifier will be compatible with all other computer systems and synchronize the space information in their database.

Furthermore, the Building Boxel provides a method to create a planetary database containing all the GIS footprints of all the spaces (floors, rooms and project zones) and equipment either in a building, on a building or on a site stored in several databases.

Archidata invented this concept to help building operators locate equipment regardless of the evolution of a building's spatial structure. The location of the equipment is identified and sent to the IWMSs.

### BENEFITS

- Space unit smaller than a room, permanent in space and time
- Equipment, project drawings and documents easily located in relation to a floor (interactive)
- Geolocation of major projects or asset maintenance projects in a georeferenced framework
- Simplification of databases by modeling relationships between equipment, systems and spaces

### Smart Property Management

Since 1995, Archidata offers a web solution for real estate managers. The plans archived on the Archidata platform are leveraged by extracting the information needed for space management and making it accessible rapidly and securely.

### Reliable information when you need it

The Archidata Solution integrates with existing management systems. It is a global solution that follows the life cycle of a building. Our platform offers a set of tools for three sectors of activities: assets, operations and projects. Many tools are offered to provide reliable information for all real estate activities.

### UNITED STATES OF AMERICA

Toll-free: 1-855-870-1770

#### NEW YORK (Head Office)

641 Lexington Avenue,  
14<sup>th</sup> floor, New York,  
NY 10022, USA

T. +212-634-6408

F. +212-634-6409

#### PLATTSBURGH

48 Spellman Street  
Plattsburgh, NY 12901, USA  
T. +518-825-0166

### CANADA

Toll-free: 1-866-870-1770

#### MONTREAL (Head Office)

333 Notre-Dame Street East,  
# 108, Montreal, Quebec,  
Canada H2Y 3Z2

T. +514-876-1770

F. +514-876-4509

#### TORONTO

1 Yonge Street, # 1801  
Toronto, Ontario, Canada  
M5E 1W7

T. +416-214-7829

F. +416-369-0515

[archidata.com](http://archidata.com)

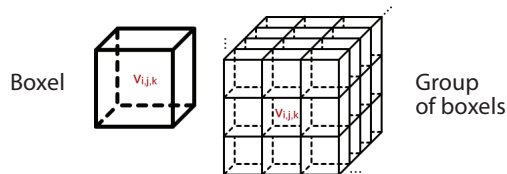

### Earth Matrix

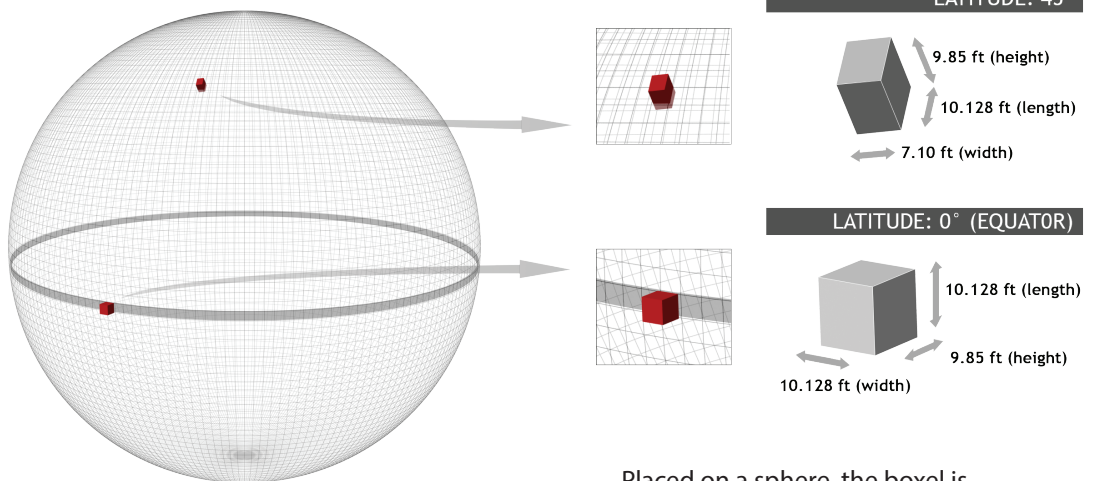

### Boxels on a floor plan

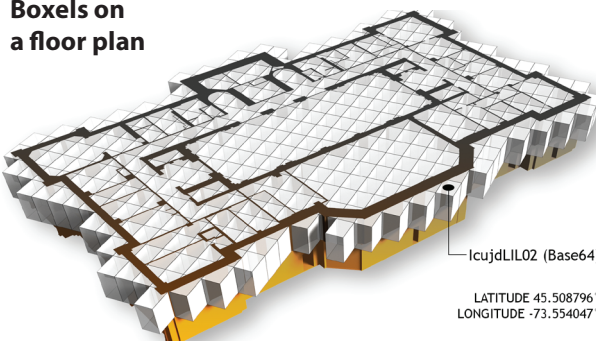

Placed on a sphere, the boxel is represented by a nearly perfect cube at the equator and a parallelepiped more and more elongated when approaching the poles. The matrix of boxels which covers the ground contains 360x60x60x10x160x60x60x10x600 boxels.

Each boxel has a unique alphanumeric identifier.

